

GENERAL CONSTRUCTION NOTES

OVERHEAD INSTALLATION & REMOVAL:

- THIS DESIGN SHALL CONFORM TO THE PG&E ELECTRIC DESIGN STANDARDS, SPECIFICALLY TD-9001M – CHAPTER 15 (OVERHEAD FIRE AREA AND SYSTEM HARDENING DESIGN GUIDANCE) MUST BE FOLLOWED FOR ALL HARDENING PROJECTS.
- POLE, ANCHOR AND EQUIPMENT INSTALLATION/ PLACEMENT MUST COMPLY WITH THE JOB DESIGN AND CONSTRUCTION DOCUMENTS. WHEN DEVIATION FROM THE ORIGINAL DESIGN IS REQUIRED DUE TO FIELD CONDITIONS, THE ORIGINATING ENGINEERING DEPARTMENT MUST BE NOTIFIED AND WILL DETERMINE IF THE DEVIATION WILL REQUIRE ADDITIONAL CALCULATIONS OR RE-DESIGN.
- USE TRIANGULAR CROSSARM FRAMING WITH PG&E-APPROVED, BONDED, COMPOSITE CROSSARM, AS DESCRIBED IN DOCUMENT 068180.
- ENSURE THAT ALL RISERS, TRANSFORMERS, AND EQUIPMENT ARE FULLY BIRD-/ ANIMAL GUARDED AND INCLUDE INSULATED JUMPERS, AS DESCRIBED IN DOCUMENT 061149.
- REPLACE OBSOLETE GRAY ALUMINUM WEATHERPROOF AERIAL CABLE (AWAC) SECONDARY AND GRAY SERVICES WHEN ENCOUNTERED.
- USE SECONDARY BREAKAWAY DISCONNECTS, WHERE APPLICABLE, FOR ALL NEW OVERHEAD SERVICE DROP CONNECTIONS, ALL SERVICE MAINTENANCE, AND REPLACEMENT WORK AS DESCRIBED IN DOCUMENT TD-041010-B004.
- REPLACE EXISTING SPLIT BOLT CONNECTORS WHEN CONSTRUCTING OVERHEAD SYSTEM HARDENING PROJECTS.
- WHEN INSTALLING NEW FUSES OR REPLACING FUSES, INSTALL OVERHEAD FAULT INDICATORS AT THE FIRST AVAILABLE LOCATION OFF THE MAIN LINE CIRCUIT AS DESCRIBED IN DOCUMENT 064048.
- ALL EXISTING SMART METER DEVICES ARE TO REMAIN IN LIKE PLACE AND BE RE-FED.
- ALL SOLELY OWNED POLES, WIRE EQUIPMENT ETC. THAT ARE TO BE REMOVED MUST BE FULLY REMOVED FROM PRIVATE PROPERTY OR FRANCHISE AREAS PRIO TO DEMOBILIZATION.
- IF THERE ARE MATERIAL ACQUISITION ISSUES WITH POLES SIZES, IT IS ACCEPTABLE TO SUBSTITUTE WITH SAME HEIGHT & BETTER CLASS THAN LISTED ON ESTIMATE.
- INTUMESCENT WOOD POLES ARE REQUIRED IN FIRE AREAS WHERE THE LOCATION IS LINE TRUCK ACCESSIBLE YEAR ROUND.
- DO NOT INSTALL CALFIRE NON-EXEMPT EQUIPMENT.
- NEW LINE RECLOSERS HAVE CALFIRE EXEMPT STATUS, BUT STILL REQUIRE CLEARING AROUND THE POLE LOCATION, PER 094669.
- ALL SCADA LOCATIONS MUST BE BUCKET TRUCK ACCESSIBLE YEAR ROUND.

RETAINING WALLS & BARRIER POSTS:

- INSTALL RETAINING WALL PER GREENBOOK/UNDERGROUND ELECTRIC ENGINEERING DOCUMENTS/051122
- INSTALL BARRIER POSTS PER PER GREENBOOK/UNDERGROUND ELECTRIC ENGINEERING DOCUMENTS/051122

LAND RIGHTS AND EASEMENTS:

- PG&E TO OBTAIN ADEQUATE P.U.E.'S AND/OR R.O.W.'S WHERE NEEDED TO MEET MINIMUM CLEARANCES AND PROTECTIONS FOR ELECTRIC FACILITIES. ELECTRIC ESTIMATOR TO CLEARLY DELINEATE THE AREA NEEDED ON THE CONSTRUCTION DRAWING WITH DIMENSIONING AND EXACT SPECS NEEDED.

SAFETY AND WORKMANSHIP:

- NOTIFY USA (1-800-227-2600) 48 HOURS PRIOR TO DIGGING FOR UNDERGROUND LOCATING.
- MATERIALS AND WORKMANSHIP SHALL BE FIRST QUALITY IN EVERY RESPECT, PLUMB AND TRUE, AND ACCORDING TO THE SPECIFIC REQUIREMENTS OF THE DRAWINGS AND THE ABOVE APPLICABLE NOTES AND SPECIFICATIONS.
- THE CONTRACTOR IS TO VERIFY ALL PROPOSED INSTALLATIONS, CONDITIONS & SPECIFICATIONS PRIOR TO COMMENCING WITH ANY PORTION OF WORK. ANY DISCREPANCIES, DELETIONS OR INCONSISTENCIES ARE TO BE REPORTED TO THE PG&E REPRESENTATIVE IMMEDIATELY. THE CONTRACTOR SHALL COMPLY WITH ALL APPLICABLE SPECIFICATIONS. ANY VARIATIONS FROM PLANS OR SPECIFICATIONS RELIEVES PG&E OF ALL RESPONSIBILITY FOR THE SUBSTRUCTURE OR DESIGN.

PROJECT SPECIFIC NOTES

- REMOVE 4,449' OF OH PRIMARY, 72' OH SECONDARY, 150' OH SERVICE CONDUCTOR, 2 SOLELY OWNED POLES, TOPPING 9 JOINT POLES & 3 OH TX'S.
- INSTALL 3,052' OF 1Ø OH 1/0AR XLPE TREE WIRE PIRMARY, 1,397' OF 3Ø OH 1/0AR XLPE TREE WIRE PRIMARY, 72' OH SECONDARY, 150' OH SERVICE CONDUCTOR, 2 SOLELY OWNED POLES, 9 JOINT POLES, 3 OH TX'S, 2 SET OF LINE CUTOUTS & 1 OH SWITCH.
- HELICOPTER SET REQUIRED FOR LOC # 2.
- CONTACT EL DORADO COUNTY AIRPORT MANAGER JEREMY GUTENBERGER 530-622-0459 PRIOR TO DOING ANY WORK AT AIRPORT. IF REPEATED ACCESS TO AIRPORT IS REQUIRE TEMP ACCESS BADGES CAN BE REQUEST FROM AIRPORT MANGER.
- BUGGY NEEDED TO ACCESS POLE LOC # 17 TO 21.

ELECTRIC DESIGN LAYOUT

PLACERVILLE 1112 PH: 2.2
 PLACERVILLE, CA 95667
 PM# 35549200

WORK SUMMARY	
TOTAL PRIMARY 3φ OH CIRCUIT FT INSTALLED	1,397'
TOTAL PRIMARY 1φ OH CIRCUIT FT INSTALLED	3,052'
TOTAL SECONDARY OH CIRCUIT FT INSTALLED	72'
TOTAL SERVICE OH CIRCUIT FT INSTALLED	150'
TOTAL PRIMARY OH CIRCUIT FT REMOVED	4,449'
TOTAL SECONDARY OH CIRCUIT FT REMOVED	72'
TOTAL SERVICE OH CIRCUIT FT REMOVED	150'

EQUIPMENT SUMMARY		
TYPE	SCADA (Y/N)	QTY.
OH SWITCH (EA.)	N	1
CAPACITOR (EA.)		N/A
RECLOSER (EA.)		N/A
FUSE/DISCONNECT (EA.)	N	2
REGULATOR (EA.)		N/A
OH 1PH TRANSFORMER (EA.)		3
OH 3PH TRANSFORMER (EA.)		N/A

SUBSTRUCTURE SUMMARY	
TYPE	QTY.
TOTAL SOLELY OWNED POLES INSTALLED	2
TOTAL JOINT POLES INSTALLED	9
TOTAL SOLELY OWNED POLES REMOVED	2
TOTAL JOINT POLES ABANDONED	9

VICINITY MAP
 NOT TO SCALE

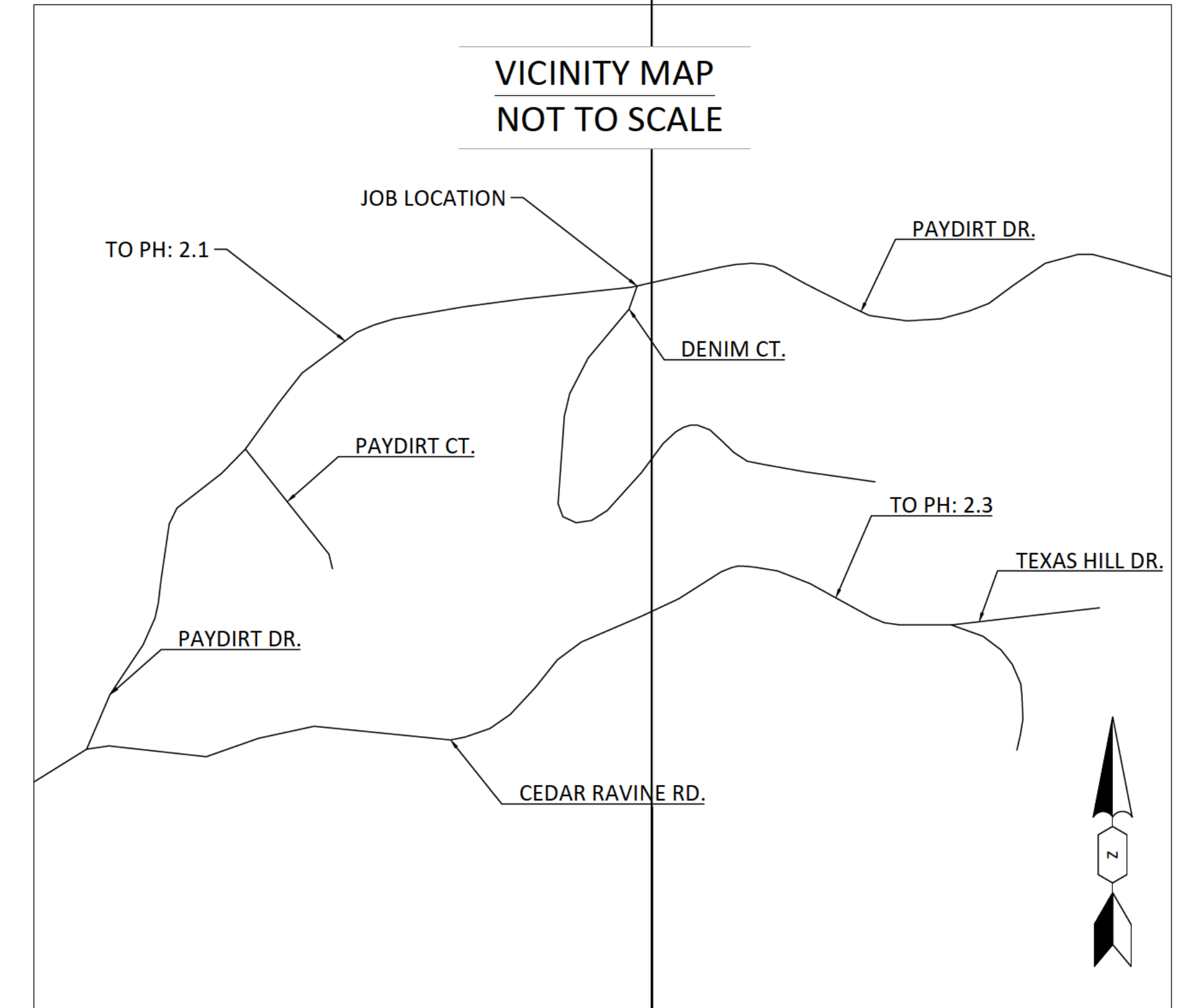

PROJECT CONTACTS

PROJECT MANAGER:	
PLANNING ENGINEER:	
DISTRIBUTION ENGINEER:	
LAND RIGHTS AGENT:	
LAND PLANNER:	
ESTIMATOR:	
ESTIMATING ADE:	
ESTIMATING SUPERVISOR:	
FIELD ENGINEER/ CM:	TBD

SCHEDULE OF SHEETS

SHEET 1	
SHEET 2	
SHEET 3	
SHEET 4 - 6	

PROJECT SPECIFIC LINSTYLES & SYMBOLS

INSTALL CONDUCTOR PROPOSED WIRE SIZE, TYPE & QUANTITY

	2-1/0A OH XLPE TW 12kv PRIMARY
	3-1/0A OH XLPE TW 12kv PRIMARY
	1/0A TPX AWAC OH SECONDARY
	1/0A TPX OH SERVICE

EXISTING CONDUCTOR

	OH SECONDARY AS LISTED
	OH SERVICE AS LISTED
	UG SERVICE AS LISTED

REMOVAL CONDUCTOR

	2 - 2AR OH PRIMARY
	OH SECONDARY AS LISTED
	OH SERVICE AS LISTED

TYPICAL LINSTYLES

	FRANCHISE RIGHT-OF-WAY LINE		RAILROAD
	PROPERTY BOUNDARY		FENCE
	EXISTING EASEMENT		BUILDING
	PROPOSED EASEMENT		WALL - EXISTING
	MINOR CONTOUR		EXISTING RETAINING WALL
	MAJOR CONTOUR		PROPOSED RETAINING WALL
	TOP OF SLOPE		GAS
	TOE OF SLOPE		WATER
	BACK OF WALK		SEWER
	SIDEWALK		STORM DRAIN
	FACE OF CURB		FIBER OPTIC
	LIP OF GUTTER		COMM (PHONE/CATV)
	EDGE OF TRAVELLED WAY		IRRIGATION
	EDGE OF PAVEMENT		ENVIRONMENTAL SENSITIVE AREA
	ROADWAY CENTERLINE		
	ROADWAY GUARDRAIL		

TYPICAL SYMBOLS

OVERHEAD			UNDERGROUND			
PROPOSED	EXISTING	REMOVE	PROPOSED	EXISTING	REMOVE	
						SOLELY OWNED POLE
						SOLELY OWNED ANCHOR
						CAPACITOR
						DISCONNECT
						SECTION VIEW CALLOUT
						MATCHLINE



PLACERVILLE 1112 PH: 2.2
 PLACERVILLE, EL DORADO, CA
 ELECTRIC DISTRIBUTION ENGINEERING
 PACIFIC GAS & ELECTRIC COMPANY
 OAKLAND, CA

PRIMARY VOLTAGE: 12 KV	VOLTAGE AREA: D
LATITUDE: 38.71921	LONGITUDE: -120.76785
SOURCE SIDE DEVICE: SWITCH 96481	
SUB & CIRCUIT: PLACERVILLE 1112	
DSGN SAG: INTMD. 450	RAPTOR ZONE: NO
LOADING AREA: INTMD.	ARRESTER DIST: 1
CORROSION AREA: NON	INSULATION DIST: D
GAS CONFLICT: Y	NEAR LOC: ALL
	FIRE AREA: SRA-TIER 2

ABBREVIATIONS

A	ALUMINUM, BARE (FORMERLY AL)	D	DEPTH	FVT	FULL VEHICLE TRAFFIC	LR	RECLOSER	PVC	POLYVINYL CHLORIDE	TEL	TELEPHONE
AB	AGGREGATE BASE	DAR	DUPLEX ACSR CABLE	FWY	FREEWAY	PVT	PRIVATE	PWR	POWER	TEMP	TEMPORARY
ABN	ABANDONED	DB	DIRECT BURIED	G	GROUND	MCM	MULTIPLE CONTRACTS BY ANY SINGLE TENANT	QAC	QUADRAPLEX AERIAL CABLE (ALUMINUM) FOR SECONDARY	TG	TOP OF GRADE
AC	ASPHALT CONCRETE	DDE	DOUBLE DEAD END	GANC	GUY ANCHOR	MED	MEDIUM	QPX	QUADRAPLEX 600V OH & UG CABLE (ALUMINUM)	TOS	TEMPORARY OUT OF SERVICE
ALM	ALUMINUM (POLE)	DE	DEAD END	GEN	GENERATOR / GENERATION	MF	MULTI-FUNCTIONAL	R	RISER	TPX	TRIPLEX CABLE 600V OH OR UG
AMP	AMPERE(S)	DEACT	DEACTIVATED	GRD	GROUND	MH	MANHOLE	R/W	RIGHT OF WAY	TRANS	TRANSMISSION
ANC	ANCHOR	DF	DEAD FRONT	GS	GUY STUB	MIL	THOUSAND OF AN INCH	RC	RADIO CONTROL	TRANSP	TRANSPPOSITION
APN	ASSESSOR'S PARCEL NUMBER	DG	DOWN GUY	HDD	HORIZONTAL DIRECTIONAL DRILL	MIN	MINIMUM	RCN	RETURN COMMON NEUTRAL	TSC	TEMPERATURE SWITCHED (CAPACITOR)
APPROX	APPROXIMATE	DI	DRAINAGE INLET	HFTD	HIGH FIRE THREAT TIER DISTRICT	MLE	MAIN LINE END	RDWY	ROADWAY	TSCV	TEMPERATURE SWITCHED WITH OVERRIDE (CAPACITOR)
AR	ALUMINUM CONDUCTOR, STEEL REINFORCED (FORMERLY ACSR), ALSO ALUMINUM NEUTRAL FOR SECONDARY CABLE	DIA	DIAMETER	HG	HEAD GUY	MLX	MAIN LINE EXTENSION	RECAP	RECAPITALIZE	TSP	TUBULAR STEEL POLE
ATS	AUTO TRANSFER SWITCH	DISC	DISCONNECTS	HP	HORSEPOWER	MOL	MAN ON LINE	REG	REGULATOR	TW	TREE WIRE
AW	ALUMAWELD MESSENGER, ALUMINUM CONDUCTOR	DIST	DISTRIBUTION	HPSV	HIGH-PRESSURE SODIUM VAPOR STREETLIGHT	MON	MONUMENT	REL	RELOCATE	TW-2	TREE WIRE, TWO-SHOT
BIA	BUREAU OF INDIAN AFFAIRS	DPX	DUPLEX 600V OH & UG CABLE (FORMERLY DUP)	HVT	HEAVY VEHICLE TRAFFIC	MP	MILE POINT	REM	REMOVE	TWR	TOWER
BM	BENCH MARK	DU	CONDUIT	I/R	IDENTIFIED FOR REMOVAL	MTR	METER	REPL	REPLACE	TX	TRANSFORMER
BP	BY PASS	DWY	DRIVEWAY	INS	INSULATOR	MV	MEGAVOLT	REV	REVISION	TYP	TYPICAL
BW	BACK OF WALK	EASE	EASEMENT	INST	INSTALL	MVAR	MAGAVAR	RLY	RELAY	U-R/W	UNOCCUPIED RIGHT-OF-WAY
C	COPPER (FORMERLY CU)	ELF	ENERGY LIMITING FUSE - LIQUID REPLACEMENT	INT	INTERRUPTER	N.C.	NORMALLY CLOSED	RO	REGULATED OUTPUT	UCD	UNDERGROUND COMMERCIAL DISTRIBUTION
CAP	CAPACITOR	EM	ELECTRONIC MARKER	ISO	ISOLATED FROM SECONDARY	NCC	NON CAPITALIZED CONDUIT	RR	RAILROAD	URD	UNDERGROUND RESIDENTIAL DISTRIBUTION
CB	CIRCUIT BREAKER (FORMERLY PCB, OCB, VCB)	ENC	ENCLOSURES/SPLICE BOXES	IVT	INCIDENTAL VEHICLE TRAFFIC	N.O.	NORMAL OPEN	S	SWITCHED	UG	UNDERGROUND
CC	CONSTANT CURRENT TRANSFORMER	ENCAP	ENCAPSULATED	JA	JOINT ANCHOR	NTS	NOT TO SCALE	S/P	SERVICE POLE	USA	UNDERGROUND SERVICE ALERT
CGC	CALIFORNIA GRID COORDINATE SYSTEM	EOL	END OF LINE	J-BOX	JUNCTION BOX	Ø	PHASE	SB	SOLID BLADE	V	VOLT / VOLTAGE
CIC	CABLE IN CONDUIT	EP	EDGE OF PAVEMENT	JP	JOINT POLE	OD	OUTSIDE DIAMETER	SD	STORM DRAIN	VA	VACANT
CIR	CIRCUIT	EPR	CABLE - ETHYLENE PROPYLENE RUBBER INSULATED	JPA	JOINT POLE ASSOCIATION	OH	OVERHEAD	SEC	SECONDARY	VAC	VACUUM
CL	CENTER LINE	EPR&H	CABLE - ETHYLENE PROPYLENE RUBBER INSULATED	JT	JOINT TRENCH	OL-1	OUTDOOR AREA LIGHTS (SCHEDULE OL-1)	SHT	SHEET	VD	VOLTAGE DROP
CL	CURRENT LIMITING	EPR&N	CABLE - ETHYLENE PROPYLENE RUBBER INSULATED	K	KILO	OP	OPEN	SL	STREET LIGHT	VF	VOLTAGE FLICKER
CLO	CLOSED	ESA	ENVIRONMENTALLY SENSITIVE AREA	KCMIL	THOUSAND CIRCULAR MIL (NEW TERM)	OJ	OPEN JUMPERS	SP	SELF PROTECTED	VIF	VERIFY IN FIELD
CMCS	CIRCUIT MAP CHANGE SHEET	EST	ESTIMATOR SKETCH ONLY	KO	KNOCKOUT (MANHOLE, ENCLOSURE)	OU	OTHER UTILITY	SS	SOURCE SIDE; SUBSURFACE	VR	VOLTAGE RISE
CN	COMMON NEUTRAL	ETW	EDGE OF TRAVELLED WAY	KV	KILOVOLTS	P	POLE	ST	STREET	VRP	VOLTAGE REGULATOR POSITION
CNCT	CONCRETE	EWS	EARLY WARNING SYSTEM	KVA	KILOVOLTS AMPERES	PCC	PORTLAND CEMENT CONCRETE	STL OR ST	STEEL	VS	VOLTAGE SWITCHED (CAPACITOR)
CO	COUNTY	F	FIXED (CAPACITOR)	KVAR	KILOVOLT AMPERES REACTIVE	PDAC	PRIMARY DISTRIBUTION ALARM CONTROL	STA	STATION	W/O	WITHOUT
CO	CUTOUTS	FB	FIRE BREAK (REQUIRED AROUND CERTAIN POLES) (FORMERLY SYMBOL "C")	KV	KILOVOLTS	P/L	PROPERTY LINE	STB	STABILIZING BANK	WP	WEATHERPROOF
CONC	CONCENTRIC	FC	FACE OF CURB	KW	KILOWATTS	PED	PEDESTAL	STD	STANDARD	WV	WORK PROCEDURE
CP	CATHODIC PROTECTION	FG	FIBER GLASS	KWH	KILOWATT HOUR	PLA	PLASTIC	SUB	SUBSTATION	WW	WATER VALVE
CRA	CITY RESPONSIBILITY AREA	LF	LIVE FRONT	LA	LIGHTNING ARRESTER	PM	PADMOUNT; POST MILE	SV	SERVICE (FORMERLY SVC)	XLP	CABLE - CROSS LINKED POLYETHYLENE INSULATED
CRZ	CLEARANCE RECOVERY ZONE	LFU	LIQUID FUSE	LB	LOAD BREAK	PMI	PADMOUNT INTERRUPTER	SW	SWITCH	XLP-CONC	CABLE - CROSS LINKED POLYETHYLENE INSULATED CONCENTRIC NEUTRAL / SHIELD
CT	CURRENT TRANSFORMER	LM	LUMEN (STREETLIGHT)	LCP	LOAD CHECK POINT	PMJ	PADMOUNT JUNCTION	SWG	SIDEWALK GUY	ZIG-ZAG	OPEN WYE TO ZIG-ZAG WYE TRANSFORMATION EQUIPMENT AND CONNECTION
CULV	CULVERT	LOC	LOCATION	LF	LIVE FRONT	PN	PRIMARY NEUTRAL - ON PRIMARY LEVEL	T-	TRANSFORMER NUMBER		
CUST	CUSTOMER OWNED	LONG	LONGITUDE	LFU	LIQUID FUSE	POT	POTENTIAL	TAC	TRIPLEX AERIAL OVERHEAD CABLE		
CVR	CONSERVATION VOLTAGE REGULATION	LPSV	LOW PRESSURE SODIUM VAPOR	LM	LUMEN (STREETLIGHT)	PRI	PRIMARY	TC	TELEPHONE CONTROLLED		
CW	COPPER WELD			LOC	LOCATION	PUE	PUBLIC UTILITY EASEMENT	TCE	TEMPORARY CONSTRUCTION EASEMENT		
				FU	FUSE	PVMT	PAVEMENT	TD	TECHNICAL DOCUMENT		

ENVIRONMENTAL ISSUES

811 Know what's below. Call before you dig.

LEGEND

PM: 35549200
NOTIF: 128663547
JPA#: PG246439HT
SCALE: N.T.S.
DATE: 9/27/2024
SHEET: 2 OF 6 REV. 0







